



CCITT G.703 D-Sub 37 Pin, Male to Female



Features:

- Connects 75 ohm dual coax to 120 ohm twisted pair
- Bi-directional signal conversion according to CCITT G.703
- Miniature size with mounting supports
- 37pins D-Sub connectors provided

Description:

The CCITT G.703 balun panel matches multiple sets of dual 75 ohm coax connections to multiple 120 ohm twisted pair connections. Supporting E1 bit rates up to 2 Mbit/s and E2 to 8 Mbit/s, the panel bi-directionally match, not only signal impedance, but also the pulse shapes of the signals according to the CCITT G.703 standard.

Specification:

Bit Rates:	2 Mbit/s (E1)	8 Mbit/s (E2)	
Impedance:	75 ohm to 120 ohm		
Insertion loss:	Max. 0.2dB	Max. 0.3dB Max. 0.9dB from 0.2-70MHz	
Return loss:	-29dB	-21B -15dB from 1 to 70 MHz	
Cross talk:	40dB typical		
Pin IN/OUT:	Port 1: 1+/2- Port 2: 3+/4- Port 3: 6+/7- Port 4:8+/9- Port 5: 11+/12- Port 6: 13+/14- Port 7: 16+/17- Port 8:18+/19- Port 9: 20+/21- Port10: 22+/ 23- Port11: 25+/ 26- Port12:27+/28- Port13:29+/30- Port14: 31+/ 32- Port15: 34+/ 35- Port16:36+/37-		
Dimension:	110*70*28 in mm		

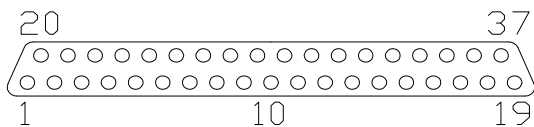

D-Sub 37pin Female(75 ohms)

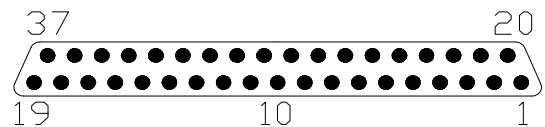

D-Sub 37pin male(120 ohms)

Installation:

1. Make the connections to all ports both at 75 ohms(Female) and 120 ohms (male) sides by following the pin IN/OUT shown above .
2. The total allowable cable lengths are subject to the constraints of the ITU/CCITT G.703 recommendation. However, we recommend a total patch cable length, including coaxial and twisted pair cabling, of no more than 180m.

Warranty:

Seller warrants that this product is to be free from defect in materials and workmanship for one (1) year. The warranty given by seller is in lieu of any other warranties, express or implied. This warranty does not apply to units abused through misuse or subjected to improper and/or excessive voltage, beyond our control. Seller assumes no responsibility for damages or penalties incurred resulting from the use of this product. Seller's liability under any warranties shall be discharged by replacing or repairing, at our option, the defective product. Seller's liability for any product shall not exceed a refund of the purchase price. The warranty listed here is intended only as a summary of your full and complete warranty.

Caution:

Do not attempt to open the body, as there are no user-serviceable parts inside Balun. Opening the unit will void your warranty.

REV.	DESCRIPTION	DATE	APPROVED
1	Initial Version	99.01.19	Byrron

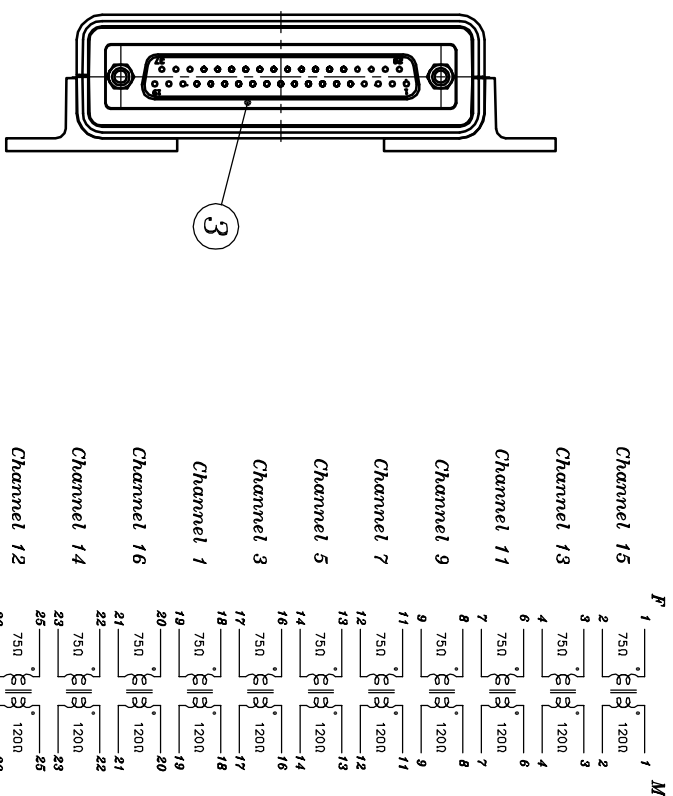
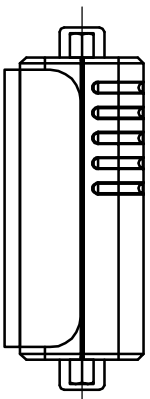
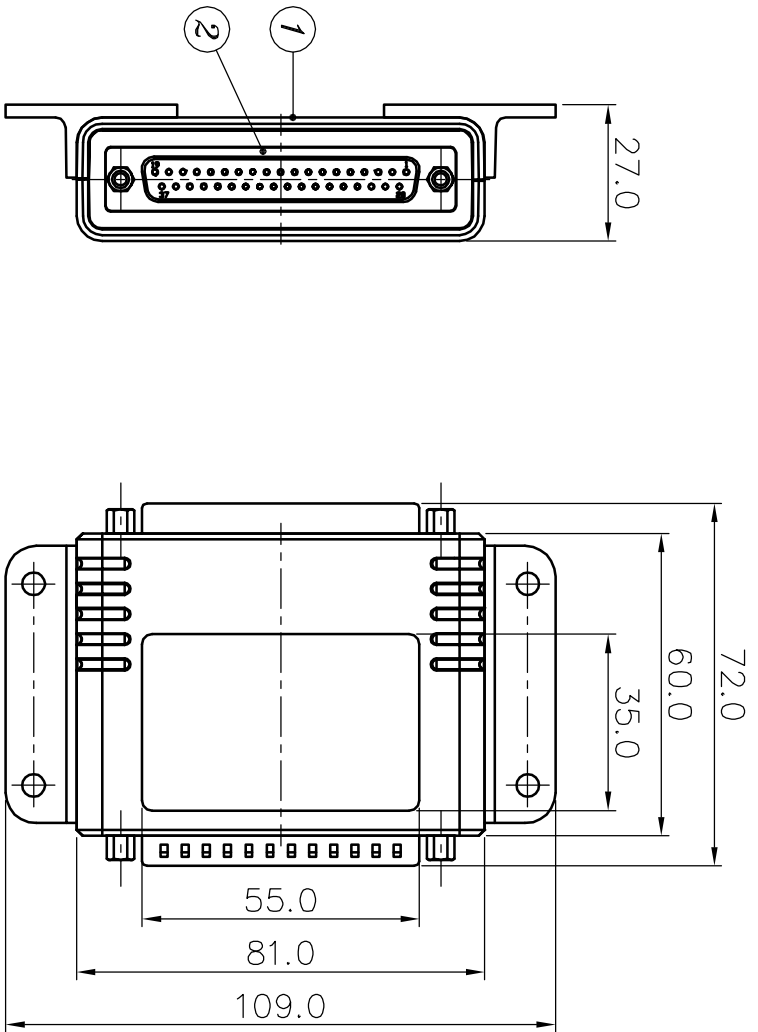

TECHNICAL SPECIFICATION:

- *Data Rates to 2.048 Mbps
- *Speed Ranges 2-8 Mbit/s
- *75 Ohm Coax to 120 Ohm Twisted Pair
- *Bi-Directional Signal Conversion
- *No AC Power or Batteries Needed
- *INSERTION LOSS ≤ 0.2dB(E1)/0.3dB(E2)
- *SIGNAL RETURN LOSS ≥ -29dB(E1)/-21dB(E2)
- *GROSS TALK LOSS ≥ -40dB

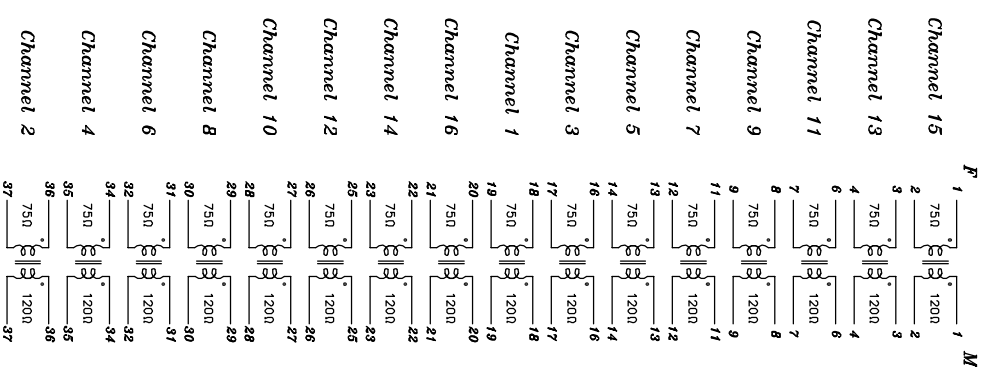

UNLESS OTHERWISE SPECIFIED
 TOLERANCE ARE:
 FRACTIONS DECIMALS ANGLES
 X ±0.1 ±0.5°
 XX ±0.05

CONTRACT NO.
 APPROVALS
 DRAWN
 CHECKED
 ISSUED

LEMMAR INDUSTRIAL CORP.
 CCITT BALUN
 D-SUB 37P MALE+FEMALE

NO	DESCRIPTION	MATERIAL	REMARK	QTY
3	D-SUB 37P MALE			1
2	D-SUB 37P FEMALE			1
1	PLASTIC SFT (TOP,BOTTOM & SIDE COVER)	ABS(UL94V-0)		1

MATERIAL FINISH
 DO NOT SCALE DWG.

DATE 99.01.19
 BYRRON

SIZE A4
 PSCHE NO. RB37FM0008FX
 DWG NO. RB37FM0008FX
 SCALE 1 : 1.5
 SHEET 1 OF 1